



# LATTY'S NEW PATENTED GASKET FORMAT

## An innovating solution to reduce your stocks!

Our new LATTYmultirating gasket format is a **significant advance** in the flange gasket field, **allowing them to be adapted to different pressure classes**.

This ingenious approach gives our clients the possibility of **managing several flange classes with a single gasket reference**, thereby considerably reducing incorrect gasket selection risks. This LATTYmultirating gasket design can be produced in all the qualities and thicknesses of flat gaskets proposed by LATTY.

By choosing this new design which is adaptable to the ASME B16.5 and NF EN 1092-1 standards, our customers simultaneously **simplify their stock management** and reduce stock volume. This innovation **demonstrates our commitment to providing practical and effective solutions**.

## ADVANTAGES

- Reduced stock
- Can be used in the vast majority of flange pressure categories
- Can be cut in all qualities and thicknesses of flat gaskets proposed by LATTY
- Patented LATTY solution



## USE CASES

*As per the ASME B16.5 standard*

**Thanks to this new LATTYmultirating gasket format, a single gasket reference perfectly fits all 3 pressure classes!**

There are many pressure classes for a given nominal diameter (DN) of a flange, corresponding to different external diameters (with different bore diameters and different screws).

For the same flange DN, **3 gaskets with different external diameters must be cut**: 3 external gasket diameters corresponding to 3 drilling diameters combined with the screw positions.

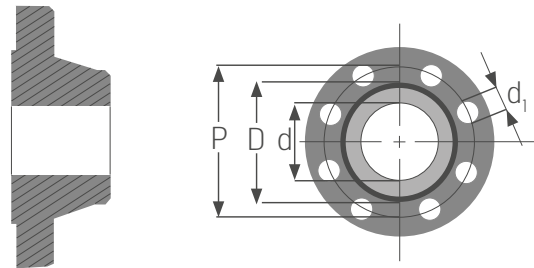

	Class #150	Class #300	Class #600
d : internal diameter (mm)	100	100	100
D : external diameter (mm)	157,2	157,2	157,2
P : drilling position (mm)	190,5	200	215,9
Number of drill holes	8	8	8
d <sub>1</sub> : drilling diameter (mm)	19	22,2	25,4
Screw diameter	M16	M20	M24
Gasket dimensions as per ASME B16.5	<b>115 x 174</b>	<b>115 x 181</b>	<b>115 x 193</b>

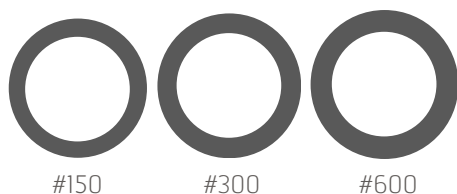

=

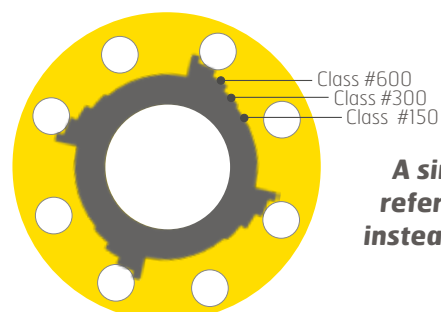

**A single reference instead of 3!**



## AS PER THE **ASME B16.5 STANDARD**

Dimensions	Pressure class	LATTY Multirating
1/2"	#150 #300 #600	1 reference of gasket instead of 3
3/4"		
1"		
1 <sup>1</sup> / <sub>4</sub> "		
1 <sup>1</sup> / <sub>2</sub> "		
2"		
2 <sup>1</sup> / <sub>2</sub> "		
3"		
4"		

Dimensions	Pressure class	LATTY multirating
5"	#150 #300 #600	1 reference of gasket instead of 3
6"		
8"		
10"		
12"		
14"		
16"		
18"		
20"		

This standard covers pressure-temperature values, materials, dimensions, tolerances, marking, testing and opening designation methods for pipe flanges and flanged connections. The ASME B16.5 standard covers steel pipe flanges and flanged connections from NPS 1/2 to NPS 24 metric/inch in pressure classes #150 to #600. For pressure classes from #900, please consult us. For higher pressure classes of #1500 and #2500, we recommend our LATTYgraf Reflex metal-to-metal contact graphite gasket.

## AS PER THE **NF EN 1092-1 STANDARD**

Dimensions	Pressure class	LATTY multirating
DN 15	PN 10 - PN 100	1 reference of gasket instead of 2
DN 20	PN 10 - PN 100	
DN 25	PN 10 - PN 100	
DN 32	PN 10 - PN 100	
DN 40	PN 10 - PN 100	1 reference of gasket instead of 3
DN 50	PN 10 - PN 100	
DN 65	PN 10 - PN 100	
DN 80	PN 10 - PN 100	1 reference of gasket instead of 4
DN 100	PN 10 - PN 100	
DN 125	PN 10 - PN 100	1 reference of gasket instead of 5
DN 150	PN 10 - PN 100	
DN 200	PN 10 - PN 100	
DN 250	PN 10 - PN 100	

Dimensions	Pressure class	LATTY multirating
DN 300	PN 10 - PN 100	1 reference of gasket instead of 6
DN 350	PN 10 - PN 25	2 references of gasket instead of 6
DN 350	PN 40 - PN 100	
DN 400	PN 10 - PN 25	2 references of gasket instead of 4
DN 400	PN 40 - PN 100	
DN 450	PN 10 - PN 16	2 references of gasket instead of 6
DN 450	PN 25 - PN 40	
DN 500	PN 10 - PN 25	2 references of gasket instead of 6
DN 500	PN 40 - PN 100	

DN: Nominal diameter - PN: Nominal pressure

According to the NF EN 1092-1 standard, the number of gasket references may vary depending on the pressure class. For PN of 100, please consult us. For PN above 160, we recommend our LATTYgraf Reflex metal-to-metal contact graphite gasket.

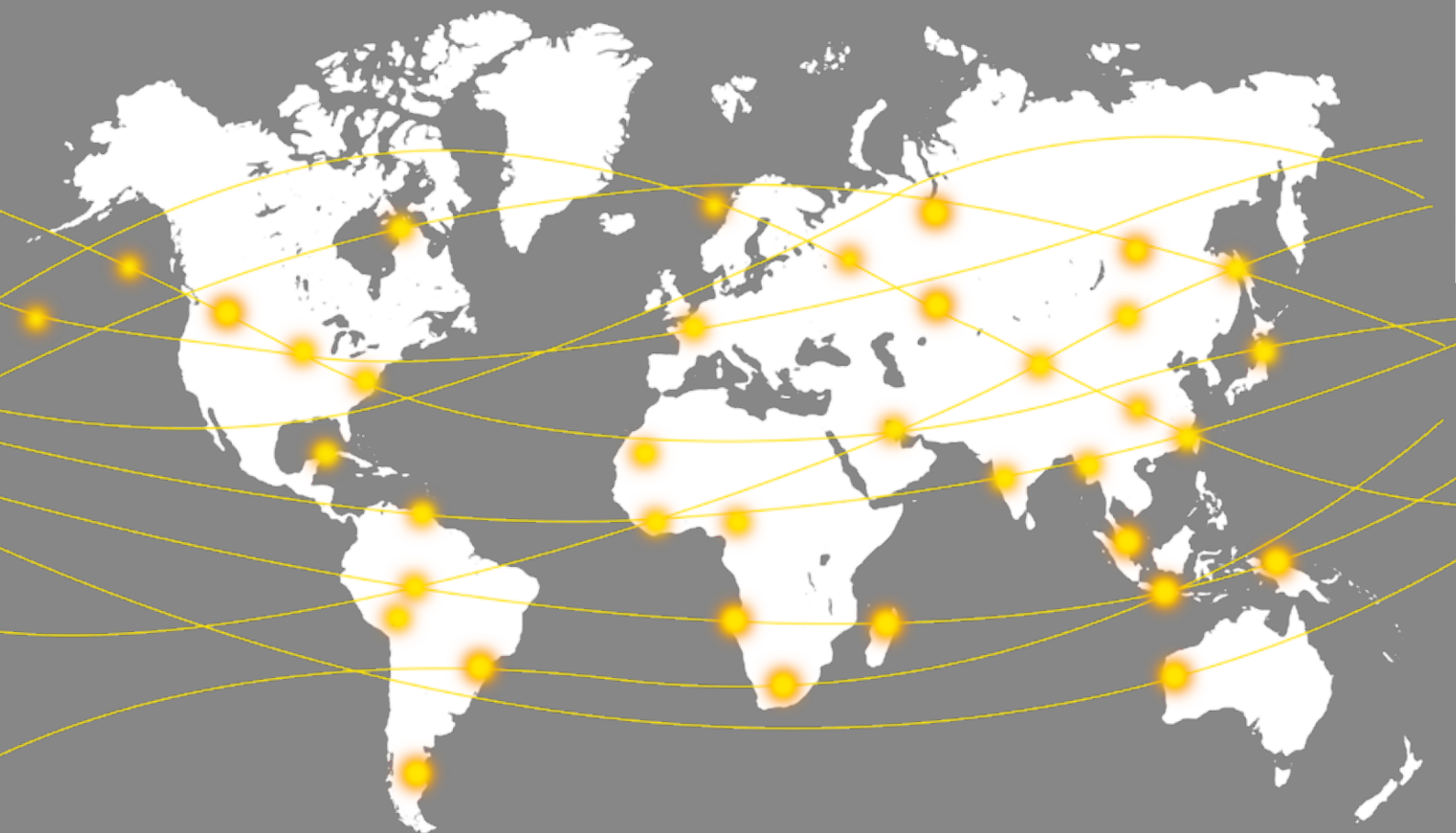

The GROUPE LATTY subsidiaries and service centres worldwide are at your disposal to respond to your requests.  
All of our contact details can be found on our website.



PRODUCTION SITE  
1, rue Xavier Latty - F-28160 BROU, FRANCE  
Tel. +33 (0)2 37 44 77 77. Fax. +33 (0)2 37 44 77 99  
customerservice@latty.com

**LATTY.COM**



LATTY BROU - Ref 9000039269 (06/2024)