

Single-seal

LATTYSEAL B 16670 A3

Dynamic sealing through complete, external balanced mechanical seal

EXTERNAL MECHANICAL SEAL LIMITING THE CONTACT WITH THE PRODUCT

- OPTION POSSIBLE FOR AGITATORS WITH AXIAL CLEARANCES
- SIMPLE AND FAST INSTALLATION
- FOR HIGHLY CORROSIVE FLUIDS

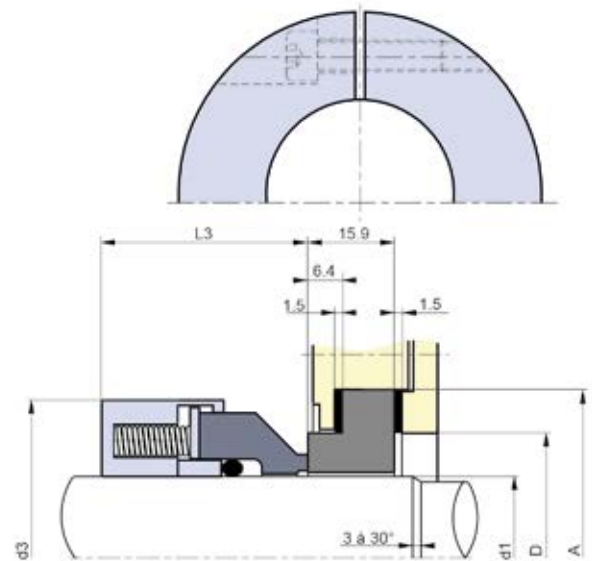

OPERATING PARAMETERS (NOT ASSOCIATED)

Pressure : 0 to 10 bar
Temperature : -20 °C to 220 °C
Speed : 15 m/s

COMPOSITION

Supplied with FKM O-ring Pure silicon carbide (U6) or resin-impregnated carbon (B1) ceramic-impregnated carbon (V)

TYPES OF INDUSTRIES



FLUIDS

All highly corrosive, abrasive and slightly clogging fluids.

GUIDELINES, STANDARDS AND APPROVALS (ON REQUEST)



Single-seal

LATTYSEAL B 16670 A3

Dynamic sealing through complete, external balanced mechanical seal

METRIC VERSION

d1 nominal h6	d3	L3	A -0 +1	D -0 + 0,2
18	44	38	46.5	34
20	46	38	49.5	38.1
22	48	38	50.5	38
24	50	38	54.5	40
25	52	38	54.5	41.5
28	55	38	57.5	45
30	58	38	63	46.5
32	60	38	60.5	48
33	60	38	60.3	49.3
35	62	38	62.5	51
38	65	38	69.9	58.2
40	68	38	73.5	60.5
43	70	38	80	64
45	72	42	83	67
48	75	42	82.6	70.4
50	78	42	89.5	70
53	80	42	88.9	73.2
55	80	42	99	76.5
58	83	42	99.2	85.3
60	86	42	99.5	78
63	90	42	105	83
65	93	42	108.5	86
68	98	42	115	88
70	98	42	115	88
75	105	42	122.5	94
80	109	42	122.5	100.5
85	114	42	122.5	103.5
90	120	42	133.5	110
95	125	42	132	113.5
100	130	42	157.5	120

IMPERIAL VERSION

d1 nominal in	d1 nominal inches	d3	L3	A -0 +1	D -0 + 0,2
0.938	15/16	50	38	50.5	40
1.000	1"	52	38	54.5	41.5
1.125	1 1/8	55	38	57.5	45
1.250	1 1/4	60	38	60.5	48
1.375	1 3/8	62	38	62.5	51
1.500	1 1/2	65	38	70.5	57.5
1.625	1 5/8	68	38	73.5	60.5
1.750	1 3/4	72	38	80	64
1.875	1 7/8	75	42	83	67
2.000	2"	78	42	89.5	70
2.125	2 1/8	80	42	96	73.5
2.250	2 1/4	83	42	99	76.5
2.375	2 3/8	86	42	99.5	78
2.500	2 1/2	90	42	105	83
2.625	2 5/8	98	42	108.5	86
2.750	2 3/4	98	42	115	88
2.875	2 7/8	105	42	118	91
3.000	3"	105	42	122.5	94
3.125	3 1/8	109	42	132	97.5
3.250	3 1/4	109	42	122.5	100.5
3.375	3 3/8	114	42	122.5	103.5
3.500	3 1/2	120	42	125.5	107
3.625	3 5/8	120	42	133.5	110
3.750	3 3/4	125	42	132	113.5
4.000	4"	130	42	157.5	120